

# Stage, Super-size Fabric Graphics

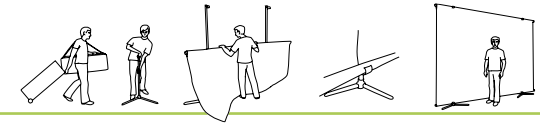

**Specifications: Stage**

**VERSIONS**  
Straight, curved.

**GRAPHIC MATERIAL**  
Super-size fabric graphics.

**WIDTH**  
Each horizontal section is 110 cm, curved or straight.  
Connect as many as you like.

**HEIGHT**  
Each vertical section is 110 cm.

**WEIGHT**  
Stage 330x220 cm compl with graphics and bag = 11.4 kg.  
Stage 440x330 cm compl with graphics and bag = 14.2 kg.

**Footprints**

335 cm  
335 cm  
335 cm  
220 cm

50 cm  
110 cm  
103 cm  
440 cm

← 440 cm →    ← 375 cm →    ← 622 cm →    ← 440 cm →

Straight Stage 4x3    Curved Stage 4x3    S-shaped Stage 6x3    Round Stage 12x2

**Ideas**

**How big do you want it?**

Unlimited in size, Stage is perfect for anything from the medium sized backdrop to the super sized trade fair. Stage is easy to mount regardless of size, meaning you won't have to mobilise half the office to build it – two should be enough. Graphics are exchanged easily and the same print can be used curved or straight, single or double-sided, giving you a system that changes when you need it to.

**Why choose a Stage**

- Modular system for full flexibility
- Quick and easy to set up
- Single or double sided
- Use the same graphics for different shapes
- Hang from the ceiling or use free standing